

HOST

Crepe Maker

Instruction manual

Model:

HOST0681CM



Read this instruction
manual carefully
before use

Safety Instructions

- Position on a flat, stable surface.
- A service agent/qualified technician should carry out installation and any repairs if required. Do not remove any components on this product.
- Consult Local and National Standards to comply with the following:
 - Health and Safety at Work Legislation
 - BS EN Codes of Practice
 - Fire Precautions
 - IEE Wiring Regulations
 - Building Regulations
- **Caution! Hot surface!** Do not touch! 
The temperature of cooking surface maybe high when the appliance is operating.
- DO NOT immerse the appliance in water.
- DO NOT clean with jet/pressure washers.
- DO NOT move or carry the appliance when it is switched on.
- DO NOT leave the appliance unattended during operation.
- Always use oven gloves when cooking or carrying out any adjustments to the appliance.
- Do not obstruct any ventilation openings in the appliance body.
- During and after cooking, the unit is still hot. Never touch the surface to avoid scalding.
- Always switch off and disconnect the power supply to the appliance when not in use.
- This appliance must only be used in accordance with these instructions and by persons competent to do so.
- Keep all packaging away from children. Dispose of the packaging in accordance to the regulations of local authorities.
- Children should be supervised to ensure that they do not play with the appliance.

- If the power cord is damaged, it must be replaced by a recommended qualified technician in order to avoid a hazard.
- This appliance is not intended for use by persons (including children) with reduced physical, sensory or mental capabilities, or lack of experience and knowledge, unless they have been given supervision or instruction concerning the use of the appliance by a person responsible for their safety.
- HOST recommend that this appliance should be periodically tested (at least annually) by a Competent Person. Testing should include, but not be limited to: Visual Inspection, Polarity Test, Earth Continuity, Insulation Continuity and Functional Testing.
- HOST recommend that this product is connected to a circuit protected by an appropriate RCD (Residual Current Device).

Installation

- Place the unit on a heat-resistant surface. Avoid placing it on or close to flammable materials. Maintain a distance of 20cm (7 inches) between the appliance and walls or other objects for ventilation.
- Keep the unit away from splashing water and countertop's edge.

Note: Before using for the first time, clean the appliance with warm soapy water. Let dry completely.

Operation

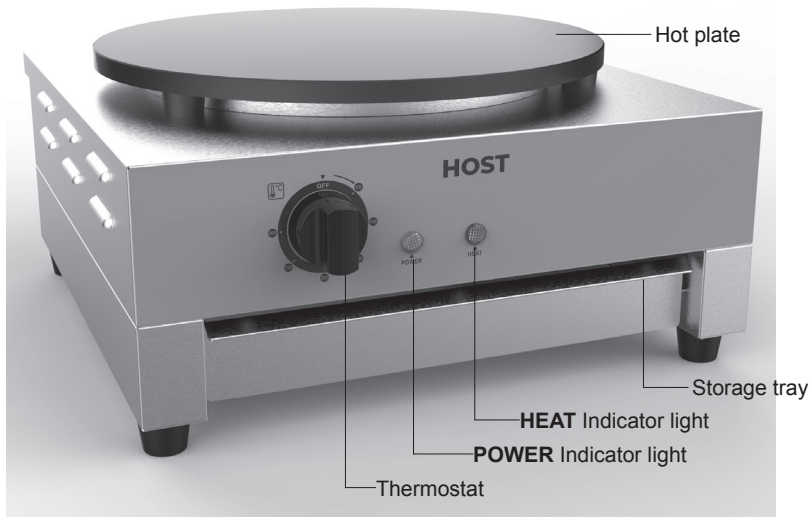

Making Crepes

1. Connect the appliance to the mains power supply. The **POWER** indicator light (green) turns on.
2. Set the thermostat to the desired temperature (50°C-300°C). The **HEAT** indicator light (orange) turns On and the appliance begins to heat up.
3. When the set temperature is reached, the **HEAT** indicator light turns Off.
4. Pour the required amount of batter mixture on to the hot plate.
5. Spread the mixture in a circular motion around the hotplate with a spreader [Fig. 1].
6. Cook on one side before flipping with a spatula to cook the other side of the crepe.
7. **Turning off:** After use, set the thermostat to **OFF** position and disconnect the appliance from power supply.

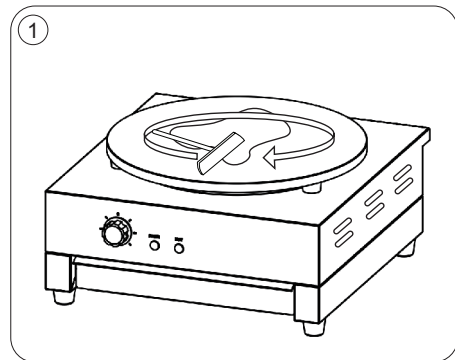

Overheating protection

This appliance is featured with an overheat protection. Should the temperature exceed safe levels the appliance will automatically cut off power.

The thermal Cut-out switch is located on the rear of the appliance. To reset the appliance after a sufficient cool-down period:

1. Unscrew the reset switch cover.
2. Press the small reset switch down until it clicks, using a blunt pointed instrument.
3. The appliance is now reset and can be used as normal.

Cleaning, Care & Maintenance

- Always switch off the appliance, disconnect the power supply and allow to cool before cleaning or performing maintenance.
- If necessary wipe the exterior with a soft cloth and warm soapy water.
- Dry thoroughly after cleaning.

Troubleshooting

A qualified technician must carry out repairs if required.

Fault	Probable Cause	Solution
The appliance is not working	The unit is not switched on	Check the unit is plugged in correctly and switched on
	Plug or lead is damaged	Replace plug or lead
	Fuse in the plug has blown	Replace the fuse
	Mains power supply fault	Check mains power supply
	Overheating protection is activated	Reset the appliance

Service

Should your appliance have a fault, please visit the Service section of the HOST website.

Technical Specifications

Model	Voltage	Power	Current	Cooking Surface Diameter	Temperature Range	Dimensions (H x W x D) (mm)	Weight (kg)
HOST0681CM	220-240V~ 50Hz-60Hz	3000W	13A	400mm	50°C-300°C	220 x 450 x 470	20.5

Due to our continuing program of research and development, the specifications herein are subject to change without notice.

Electrical Wiring

This appliance is supplied with a 3 pin BS1363 plug and lead.

The plug is to be connected to a suitable mains socket.

This appliance is wired as follows:

- Live wire (coloured brown) to terminal marked L
- Neutral wire (coloured blue) to terminal marked N
- Earth wire (coloured green/yellow) to terminal marked E

This appliance must be earthed.



If in doubt consult a qualified electrician.

Electrical isolation points must be kept clear of any obstructions. In the event of any emergency disconnection being required they must be readily accessible.

Compliance

The WEEE logo on this product or its documentation indicates that the product must not be disposed of as household waste. To help prevent possible harm to human health and/or the environment, the product must be disposed of in an approved and environmentally safe recycling process. For further information on how to dispose of this product correctly, contact the product supplier, or the local authority responsible for waste disposal in your area.



HOST parts have undergone strict product testing in order to comply with regulatory standards and specifications set by international, independent, and federal authorities.



All rights reserved. No part of these instructions may be produced or transmitted in any form or by any means, electronic, mechanical, photocopying, recording or otherwise, without the prior written permission of HOST. Every effort is made to ensure all details are correct at the time of going to press, however, HOST reserve the right to change specifications without notice.

HOST UKCA Declaration of Conformity



We {Host} of {Host House, Chepstow, NP16 6UP} hereby declare that the equipment is in conformity with the requirements of the following Regulations:

- Electrical Equipment (Safety) Regulations 2016
- Electromagnetic Compatibility Regulations 2016
- The Restriction of the Use of Certain Hazardous Substances in Electrical and Electronic Equipment Regulations 2012

We hereby declare that:

Equipment Model number **HOST0681CM** **Crepe Maker**

is in conformity with the applicable requirements of the following documents

Ref. No.	Edition/date
BS EN 60335-1	2012 +A11:2014 +A13:2017
BS EN 60335-2-38	2003 +A11:2008
BS EN 62233	2008
BS EN 55014-1	2017 +A11:2020
BS EN 55014-2	2015
BS EN IEC 61000-3-2	2019
BS EN 61000-3-3	2013 +A1:2019

I hereby declare that the equipment named above has been designed to comply with the relevant sections of the above referenced specifications and is in accordance with the requirements of the Regulations:

Signed by: 

Full Name **Jess Attree**

Title: **General Manager**

Location: **Chepstow, Great Britain**

Date: **17th June 2022**



www.host-appliances.com

HOST0681CM_EN_A5_v1_2022/08/17